

How to Add Your Island Email in macOS - IMAP

For macOS Monterey 12 or earlier



1. **Open** the *System Preferences* app  then **click** on *Internet Accounts*.

2. **Click** on *Add Other Account...*
3. **Click** on *Mail Account*.

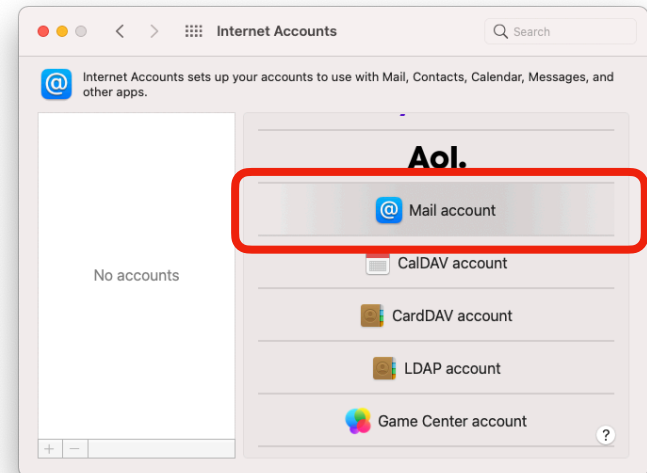
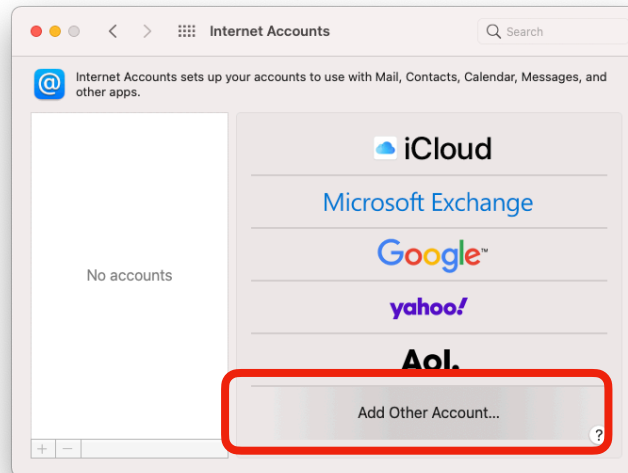

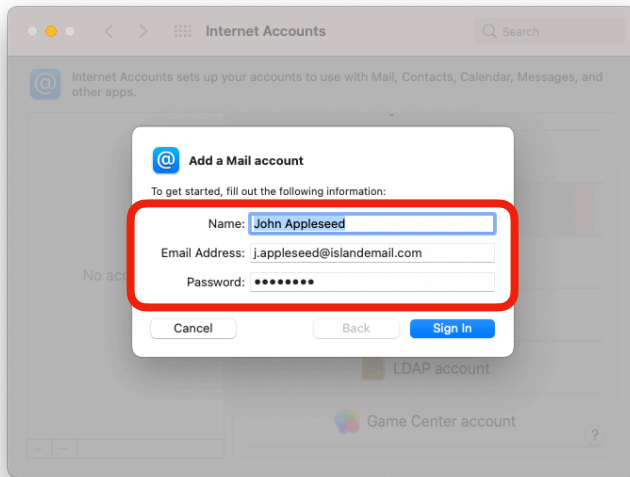

4. Enter your name, email address, & password, then **click** **Sign In**.

5. In *Account Type*, **select IMAP**.
6. Next to **Incoming Mail Server**, enter: imap.islandemail.com
7. Next to **Outgoing Mail Server**, enter: mail.islandemail.com

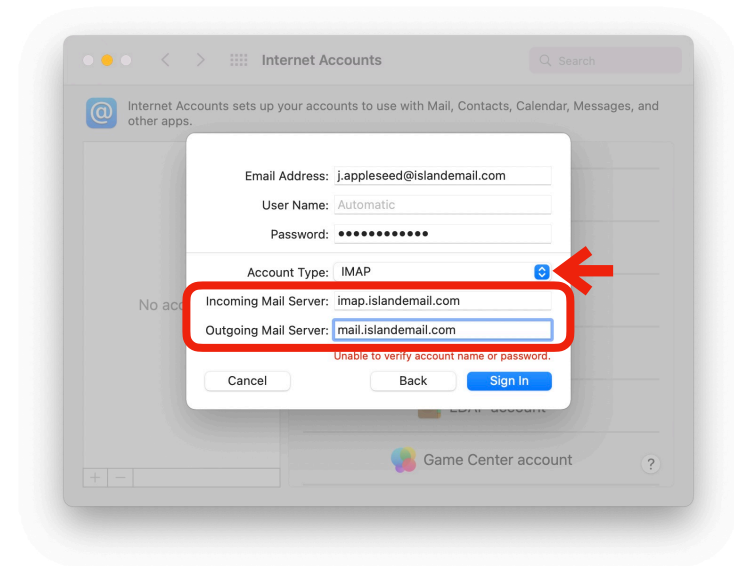

7. **Click** **Sign In**.

If the information entered is correct after being verified, be sure *Mail* is *checked*, then **click** **Done**.

